

ROAD 9
SCALE: H 1:1000,V 1:200. DATUM: 45.000

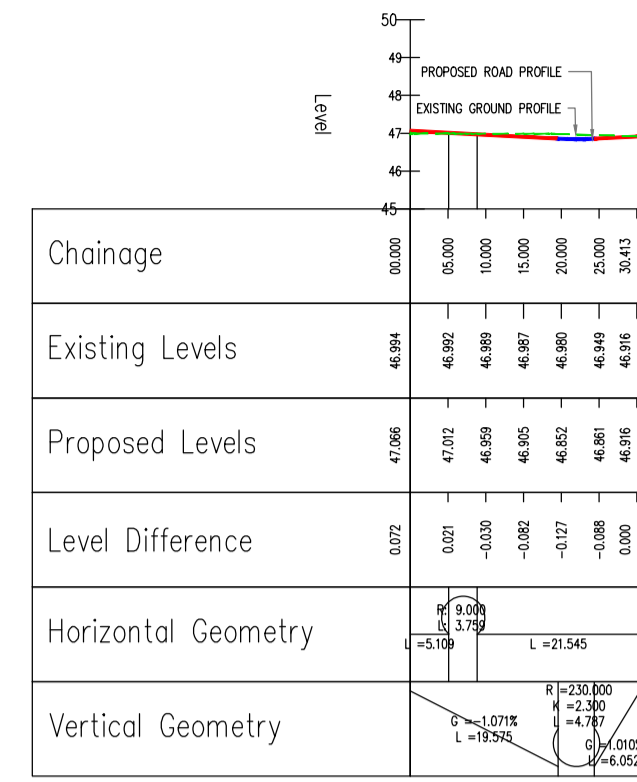

ROAD 9 A
SCALE: H 1:1000,V 1:200. DATUM: 45.000

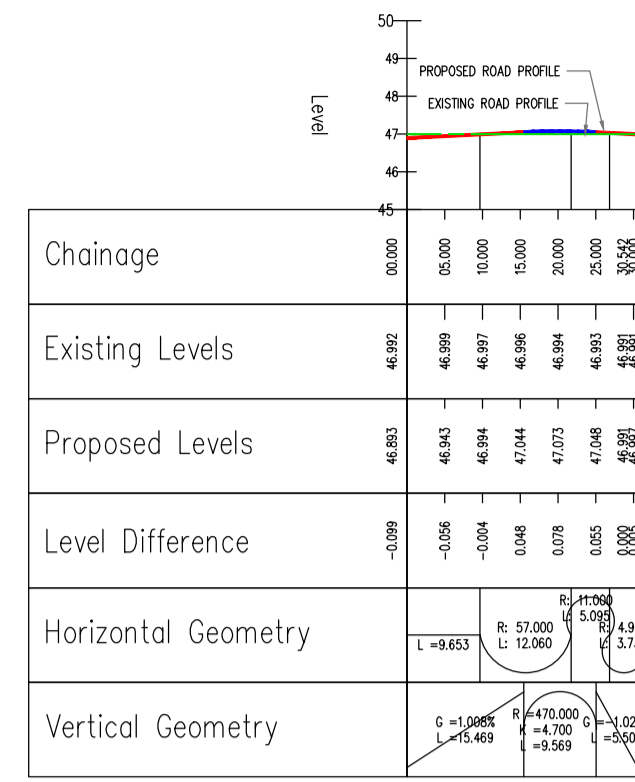

ROAD 9 B
SCALE: H 1:1000,V 1:200. DATUM: 45.000

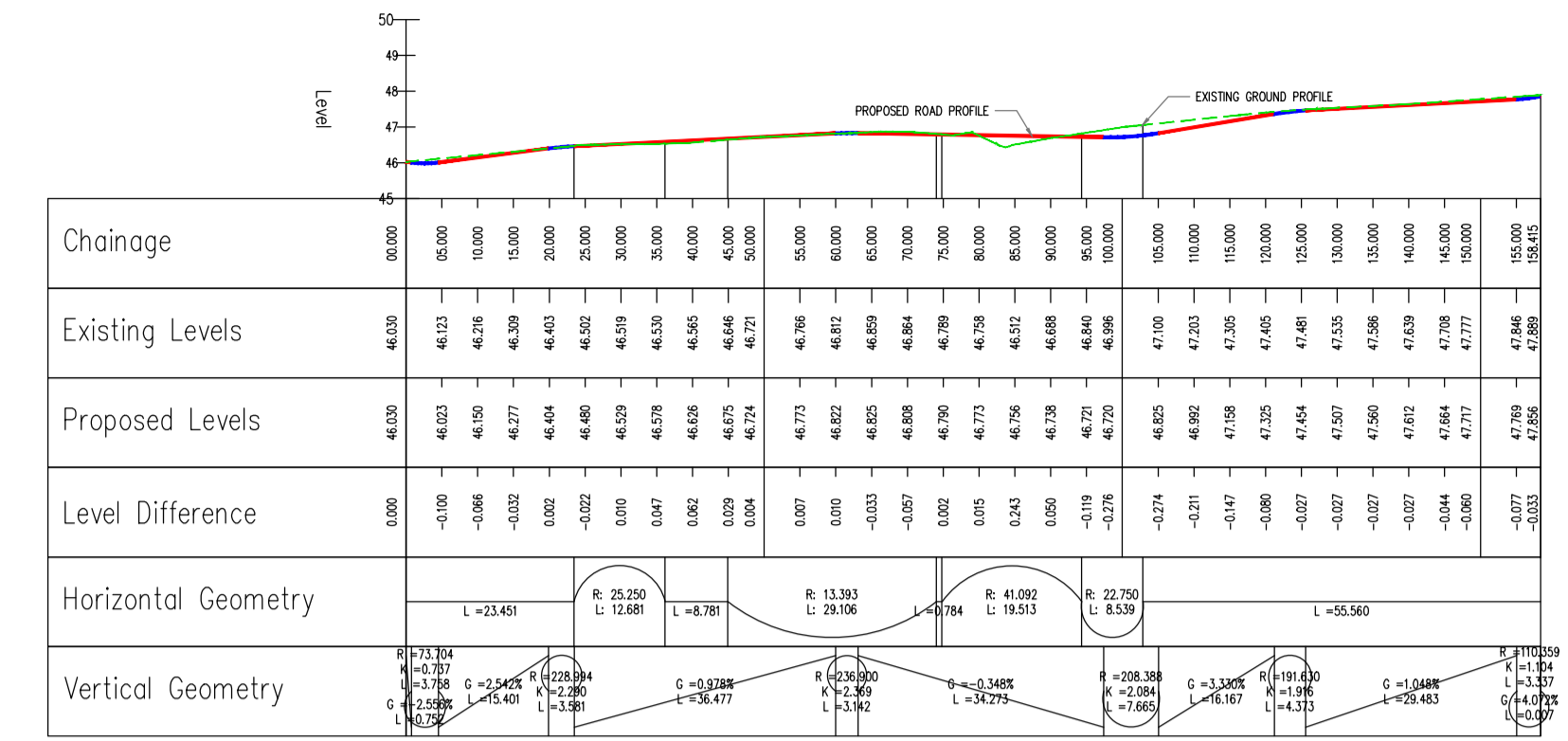

ROAD 10
SCALE: H 1:1000,V 1:200. DATUM: 45.000

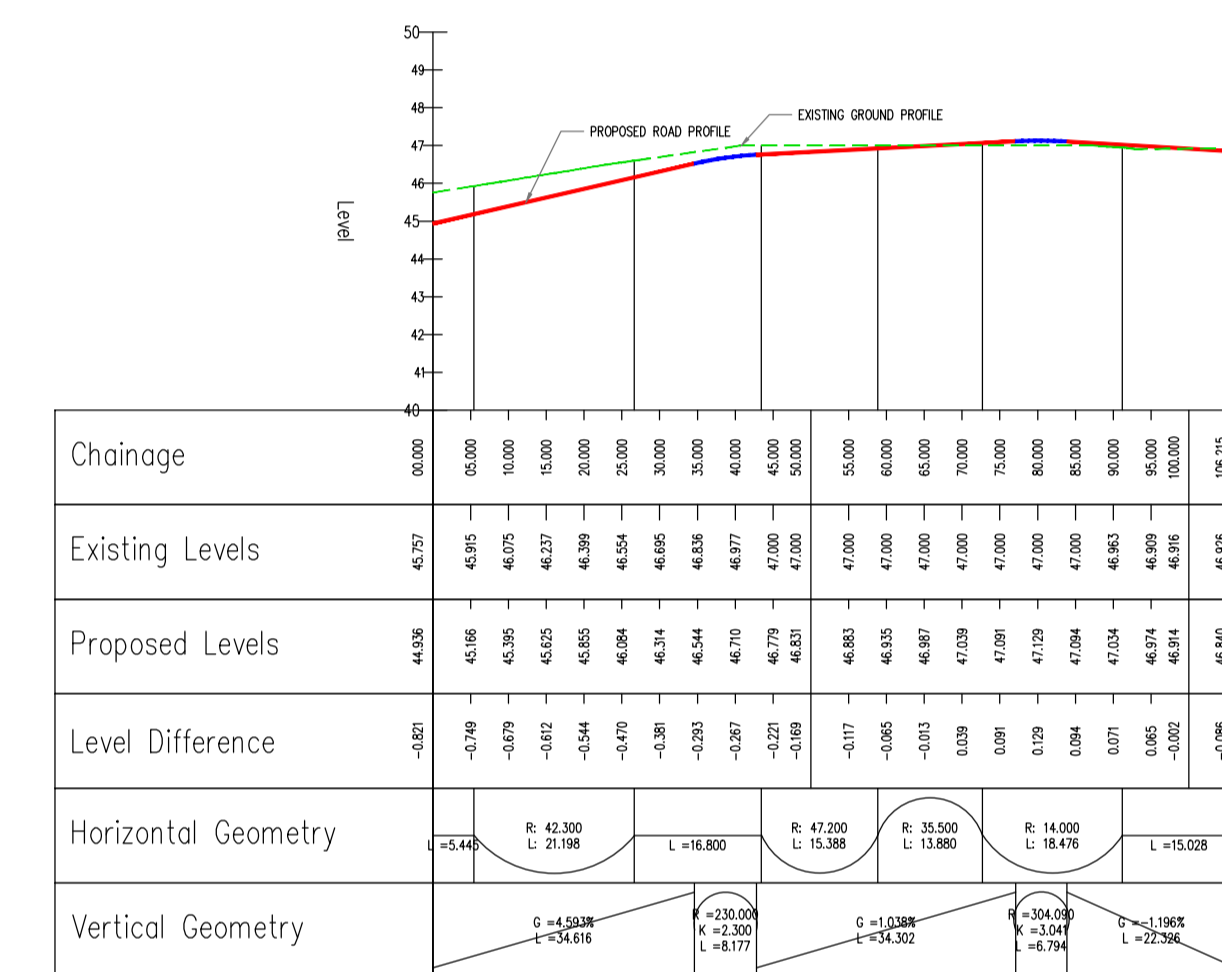

ROAD 12
SCALE: H 1:1000,V 1:200. DATUM: 40.000

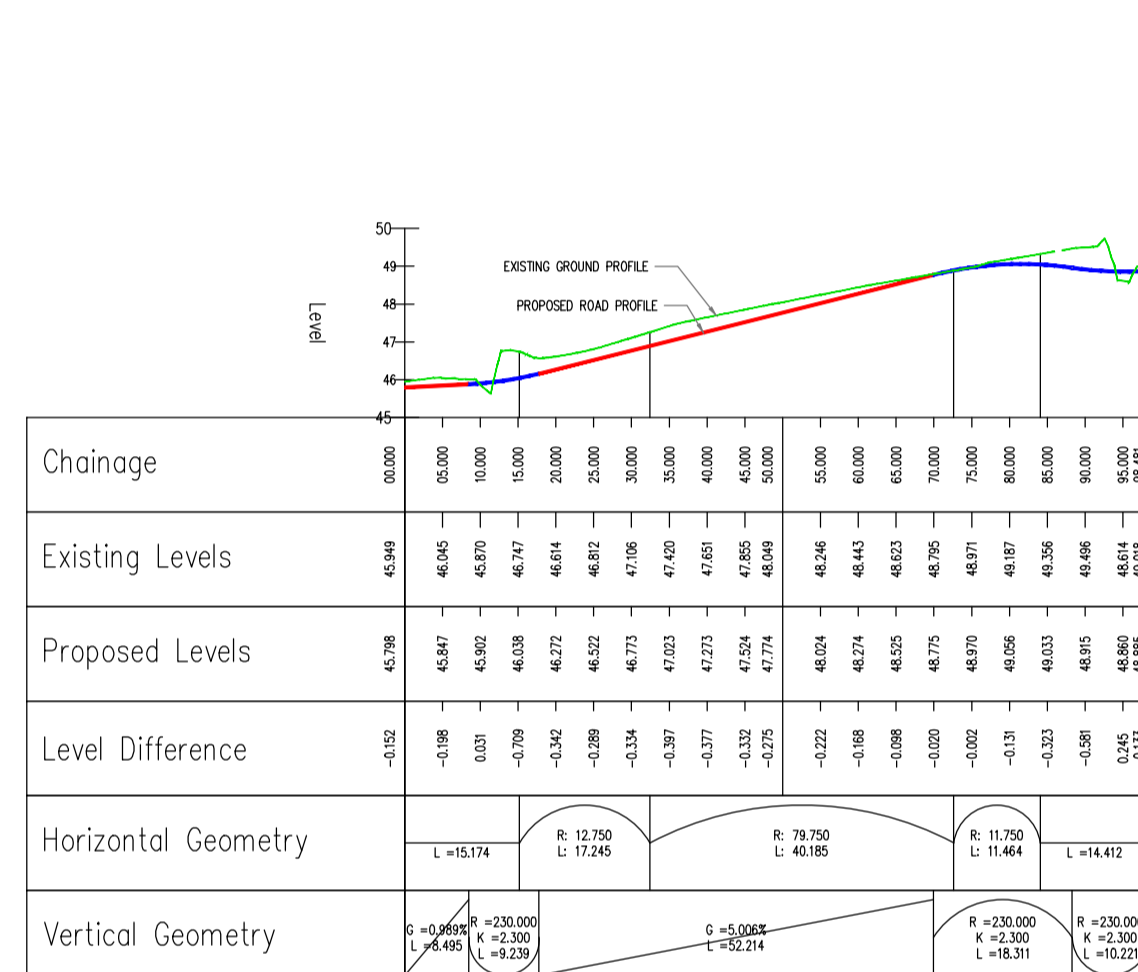

ROAD 13
SCALE: H 1:1000,V 1:200. DATUM: 45.000

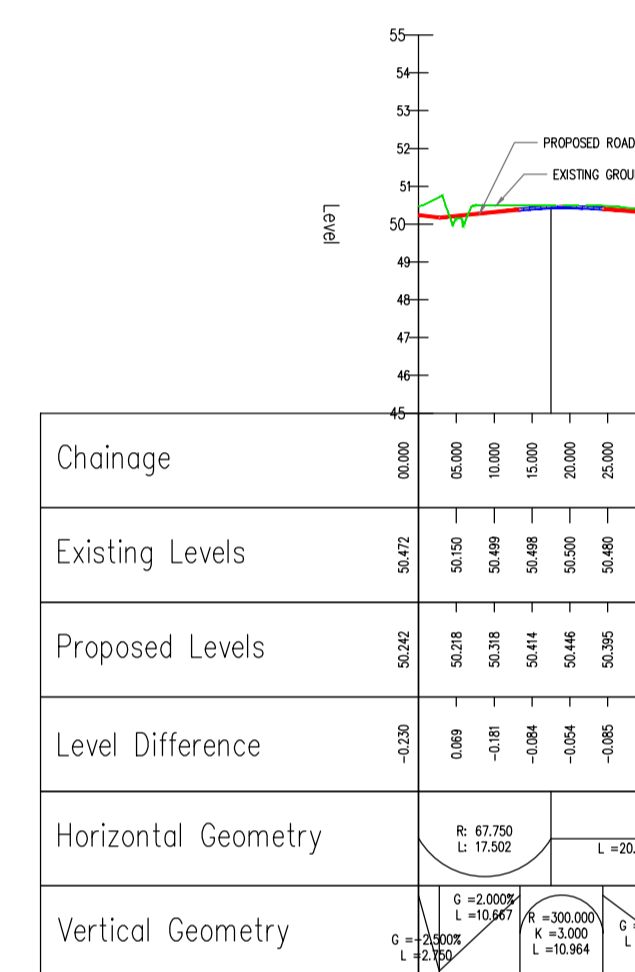

ROAD 14
SCALE: H 1:1000,V 1:200. DATUM: 45.000

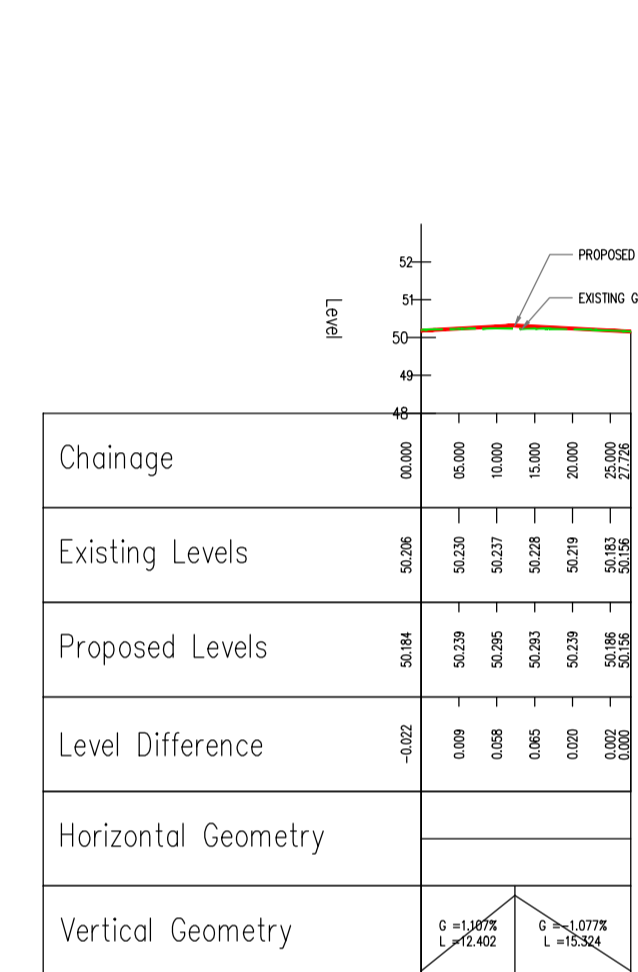

ROAD 14 A
SCALE: H 1:1000,V 1:200. DATUM: 48.000

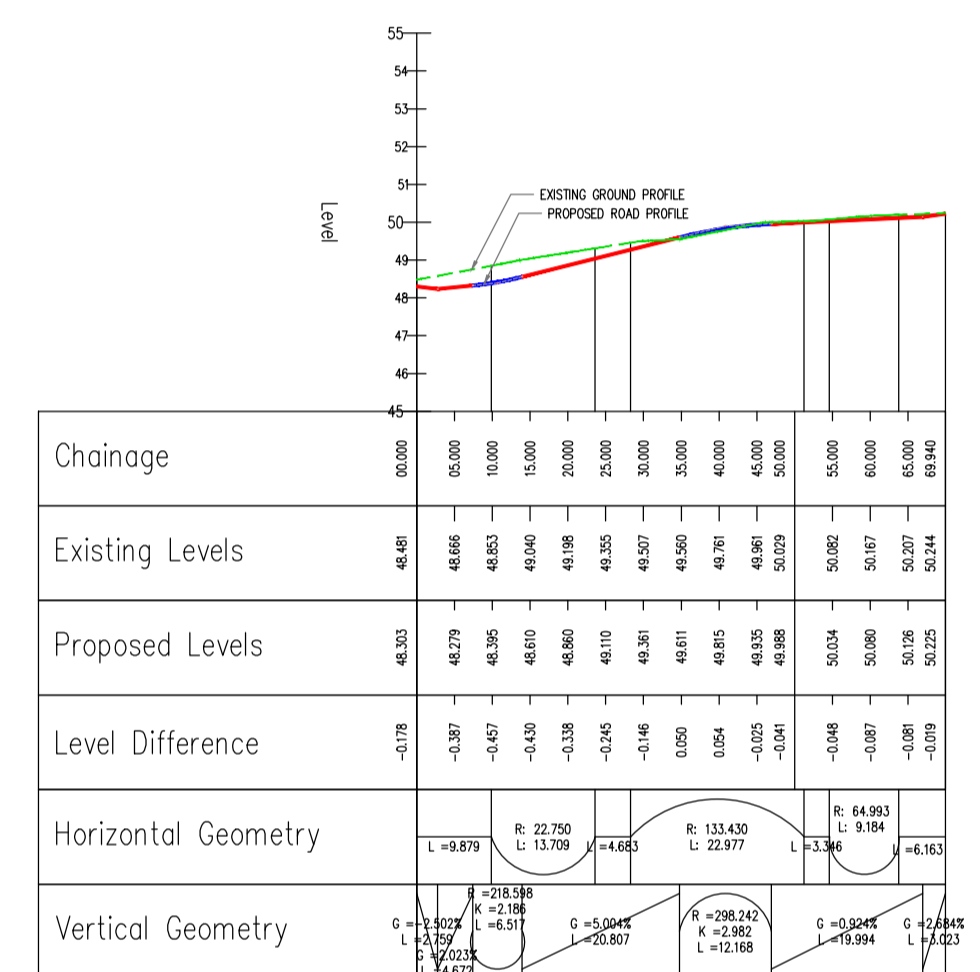

ROAD 15
SCALE: H 1:1000,V 1:200. DATUM: 45.000

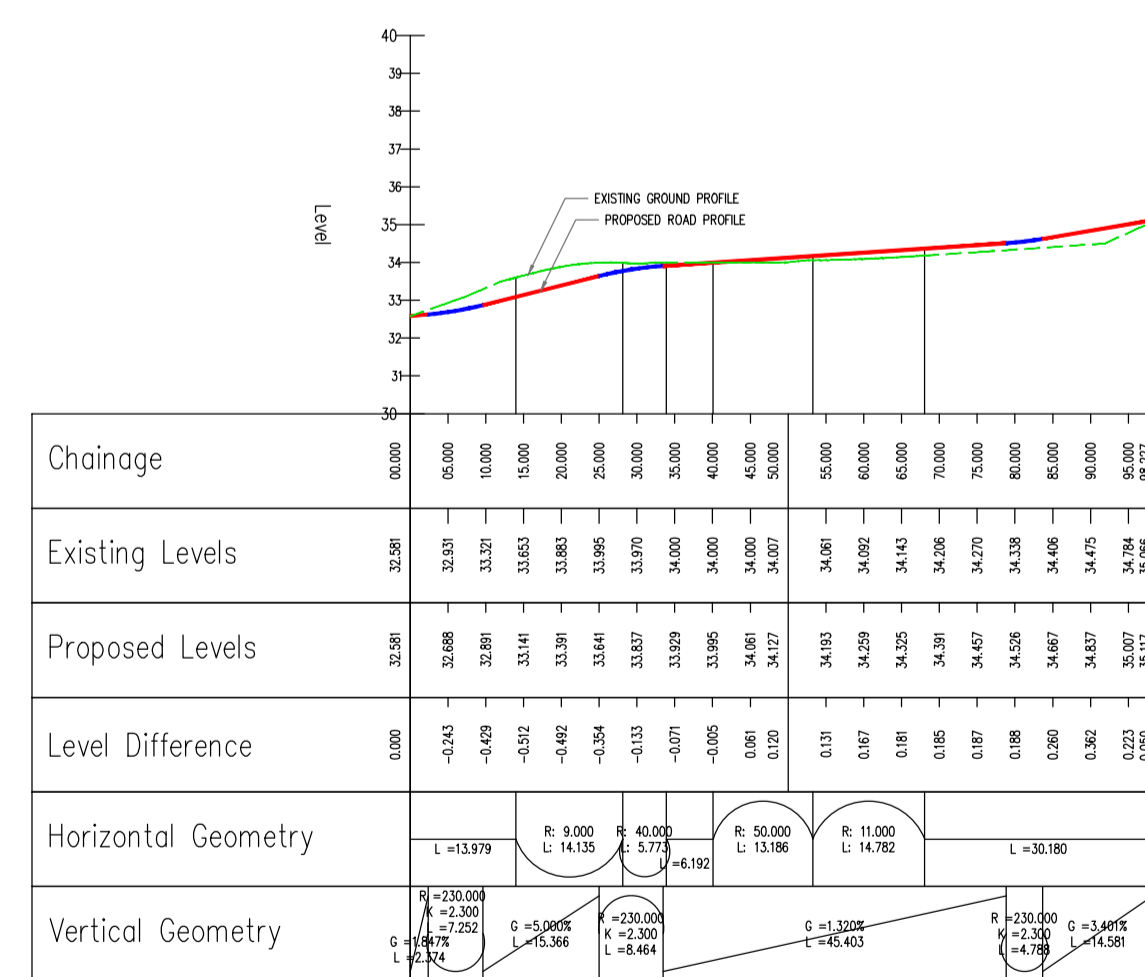

ROAD 16
SCALE: H 1:1000,V 1:200. DATUM: 30.000

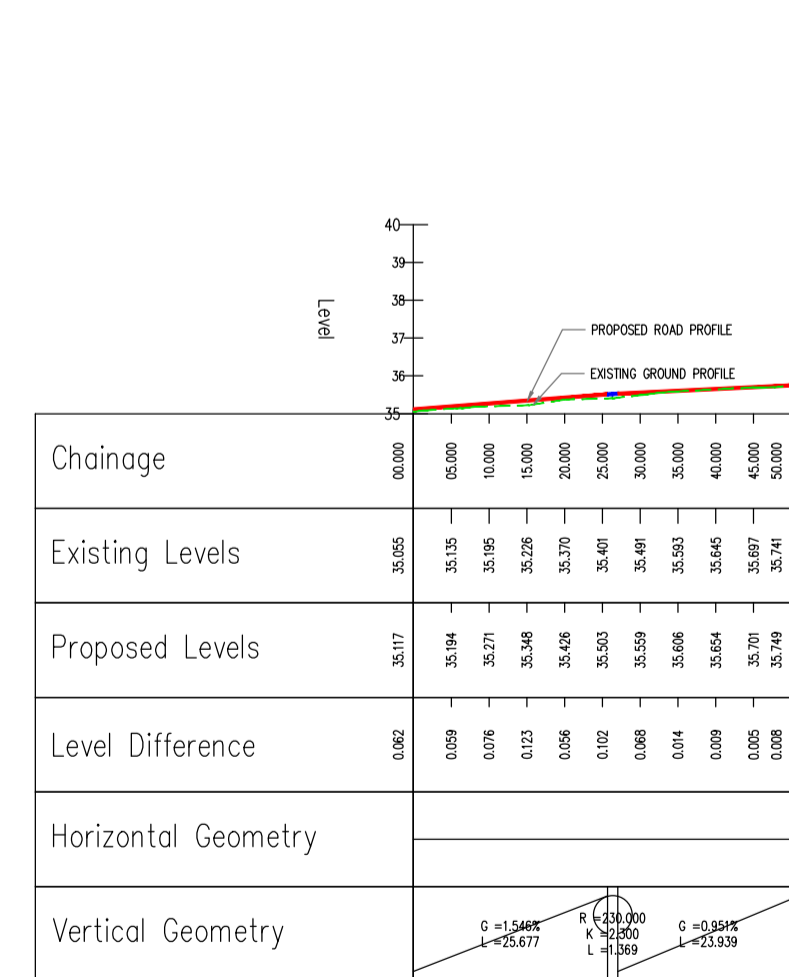

ROAD 17
SCALE: H 1:1000,V 1:200. DATUM: 35.000

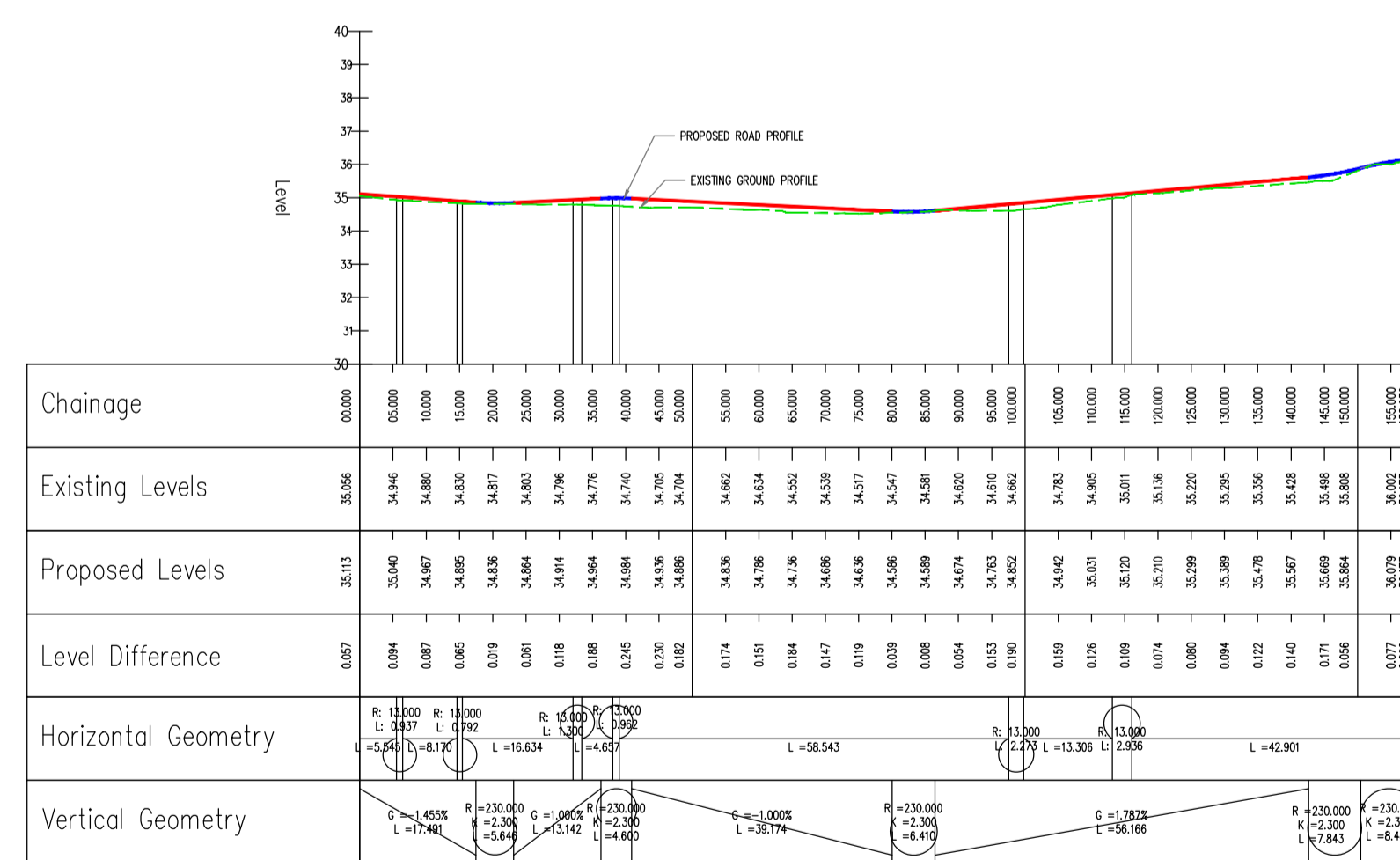

ROAD 18
SCALE: H 1:1000,V 1:200. DATUM: 30.000

NOTE:
FOR ROAD LAYOUT REFER TO DRAWINGS D061-028, D061-029, D061-030 AND D061-031.

PLANNING DRAWING
NOT FOR CONSTRUCTION THIS DRAWING HAS BEEN ISSUED FOR INFORMATION PURPOSES ONLY AND MUST NOT BE USED FOR CONSTRUCTION UNDER ANY CIRCUMSTANCES

- NOTES**
- For setting out refer to Architect's drawings.
 - This drawing to be read in conjunction with all other Architectural and Engineering drawings and all other relevant drawings and Specifications.
 - DO NOT SCALE THIS DRAWING. Use figured dimensions only.
 - No part of this document may be reproduced or transmitted in any form or stored in any retrieval system of any nature without the written permission as copyright holder except as agreed for use on the project for which the document was originally issued.
 - Ordnance Survey Ireland Licence Number EN 0074019

Rev. No.	Date	REVISION NOTE
A	01.10.2019	ARCHITECT'S LAYOUT REVISED
B	15.11.2019	ISSUED FOR PLANNING

Architect	Project	Title	Scale	Date
Conroy Crowe Kelly	Belmont	Proposed Road Profiles	AS SHOWN	Mar 2019

Drn. By	Chkd. By	Appr. By	Dwg. No.	Revision
JC	NB	NB	D061/034	B

CS Consulting Group
DUBLIN | LONDON | LIMERICK

Head Office
19-22 Dame Street, Dublin 2.
T: +353 (0)1 5480863 F: +353 (0)1 9011355
e: info@csconsulting.ie
w: www.csconsulting.ie

Quality
Environment
Energy
Health & Safety

IS. EN ISO 9001:2008
IS. EN ISO 14001:2004
IS. EN ISO 50001:2011
OHSAS 18001:2007